



SUNSET RIDGE
JEFFERSON

**Assisted Living
and Memory Care
Community**

920-541-3660



Sunset Ridge Jefferson is an assisted living community located in Jefferson, Wisconsin, that specializes in caring for individuals who suffer from types of dementia and Alzheimer's as well as advanced age.

Sunset Ridge Jefferson believes in providing our residents with high quality, and compassionate care. We strive to enhance the quality of life, preserve one's dignity, and meet social and emotional needs of each individual. By working together with family members, health professionals, and our care team, we can provide the best care possible. Quality care provided within a family oriented, community based senior living facility.

**Schedule a personal tour today,
please call (920) 541-3660 • Fax (920) 541-3662
826 E. Reinel Street • Jefferson, WI 53549**

PHILOSOPHY OF CARE



At **Sunset Ridge Jefferson** our staff of trained resident aides and certified nursing assistants specialize in dementia care. Treatments are provided for those with age-related frailties as well as memory and dementia illnesses. Whether it's a prompt response to a challenging behavior, or medication management to ease aggravation and discomfort, avoiding meltdowns and providing compassionate care is our first priority.

Sunset Ridge Jefferson believes that providing a routine based schedule tailored for each resident easily acclimates our residents to the senior living experience. Providing well rounded life enrichment programs that stimulate independence in activities of daily living, combined with personal care planning and monthly wellness checks, help maximize the quality of life for every resident while promoting good health and well being. And with a 1:6 staff to resident ratio that is lower than most facilities, you can be sure that your loved ones are receiving the individual care and attention they need.

COMFORTS OF HOME

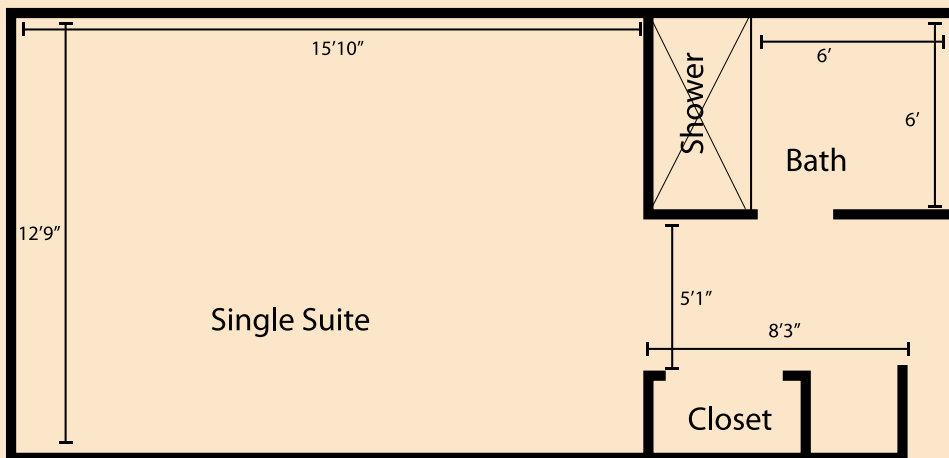

All resident rooms at **Sunset Ridge Jefferson** are private. Residents are encouraged to furnish their own suites and are welcome to bring personal furniture items, wall hangings, window treatments, and other comforts from home.

Amenities Include:

- Independent climate control
- Private bath
- Emergency call system
- Large closet and storage space
- All inclusive standard utilities
- Wireless internet access
- Satellite TV service

LEVELS OF CARE

At **Sunset Ridge Jefferson** we provide four levels of care for our residents. Each level of care represents a starting point and is tailored to the individual resident. Our levels of care range in services and are as follows:

LEVEL 1 CARE:

Private unit including housekeeping, laundry service (no dry cleaning), three meals and snacks daily, scheduled activity program, monthly wellness checks, 24-hour awake staff supervision, stand by assist with bathing, provided partial assistance with dressing and/or grooming, medication management, assistance with arranging of local transportation, provided amenities including cable television and utilities as well as all complimentary services. Shared units may be available at an adjusted fee.

LEVEL 2 CARE:

Level 2 care includes all care services listed in Level 1 Care with the addition of any or all of the following: total assistance with all personal cares, full incontinence care and/or bathroom scheduled, therapeutic diet, diabetes management, individualized exercise regime (PT support).

LEVEL 3 CARE:

Level 3 care includes all care services listed in Level 1 and 2 Care, with the addition of any or all of the following: complete assistance with any or all ADLs including hand feeding, mild behavior management, catheter care, and/or mechanical lift transfer.

LEVEL 4 CARE:

Level 4 care includes all care services listed in Level 1, 2, and 3 Care, with the addition of any or all of the following: specialized care for behavioral planning and management, management of end of life care services under the direction of hospice or home health agency.

SERVICES



Services offered at **Sunset Ridge Jefferson** are dictated by levels of care for each individual, and include the following:

- Preadmission assessment
- Hygiene assistance
- Personal care assistance
- Development of ISP's
- Medication administration
- Wellness checks
- Specialized disorder care such as for behaviors
- 24/7 on-call nurse
- On site physician
- Three home-cooked meals daily
- Nutritious snacks
- Special diet needs
- Assistance with doctor and other appointments
- Transportation needs
- Ecumenical religious services
- Complimentary barber and beauty salon services
- Incontinence care
- 24/7 alert staffing
- Alert system
- Housekeeping
- Laundry and linen services
- Social and recreational activity planning
- Exercise programs
- Coordination with other services such as therapy, hospice and home health

Services that are not included in any of the levels listed above: personal phone fees, personal toiletries, medical supplies, DME (durable medical equipment), and incontinence supplies. Foot care is available through a podiatry service.

LIFE ENRICHMENT



At **Sunset Ridge Jefferson** we believe that regular activities are the key to a happy healthy lifestyle. Providing a diverse selection of activities no only serves to encourage participation, but also promotes independence.

- | | | | |
|-------------------|----------------------|--------------|-----------------------|
| •Community Events | •Holiday Parties | •Movies | •Pet Therapy |
| •Cooking | •Day Programs | •Magic Shows | •Picnics |
| •Music | •Autumn Harvest Fest | •Zoo Program | •Exercise Programs |
| •Cards | •Baking | •Gardening | •Kinder-Kids visits |
| •Board Games | •Reading | •Crafts | •Ecumenical Religious |
| •Theatre | •Assisted Hobbies | •Barbecues | Programs |



We invite families and friends of Sunset residents to view photos and regular updates of outings, and other activities, on our Facebook page at: facebook.com/SunsetRidgeJefferson



Conveniently located in Jefferson

826 E. Reinel Street
Jefferson, WI 53549

